



Buy it for looks. Buy it for life.®

Specifications

FAUCET DESCRIPTION

- Metal construction with various finishes identified by suffix
- 1/2" IPS connections
- Lever style handles
- Handle inserts include hot (red) and cold (blue) color indicators
- Includes Protégé side spray with Hydrolock® quick connect system

OPERATION

- Hot side counterclockwise to open (clockwise to close)
- Cold side clockwise to open (counterclockwise to close)

FLOW

- Aerator is limited to 2.2 gpm (8.3 L/min).

CARTRIDGE

- 1224 cartridge design
- Nonmetallic, nonferrous and stainless steel material

STANDARDS

- Designed and manufactured to comply with the requirements of: CSA B-125, ASME A112.18.1M, ANSI A117.1 and all applicable requirements referenced therein
- Certified to ANSI/NSF 61/9
- Complies with California Proposition 65 and with the Federal Safe Water Drinking Act

- **ADA**  for lever handles

WARRANTY

- Lifetime limited warranty against leaks, drips and finish defects to the original consumer purchaser
- 5 year warranty if used in commercial installations

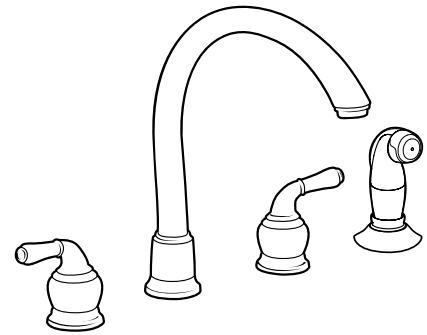

**Monticello® with Cathedral™ Spout
Two Handle Kitchen Faucet
with Protégé Side Spray**
(less handle inserts on 7000 series,
handle inserts included on 80000 series)

Models: 7786 series, 87786 series

**Spout installs through deck holes a minimum of
1-1/4" (32mm) in diameter. Valves install
through 1-1/8" (28mm) min. diameter hole.**

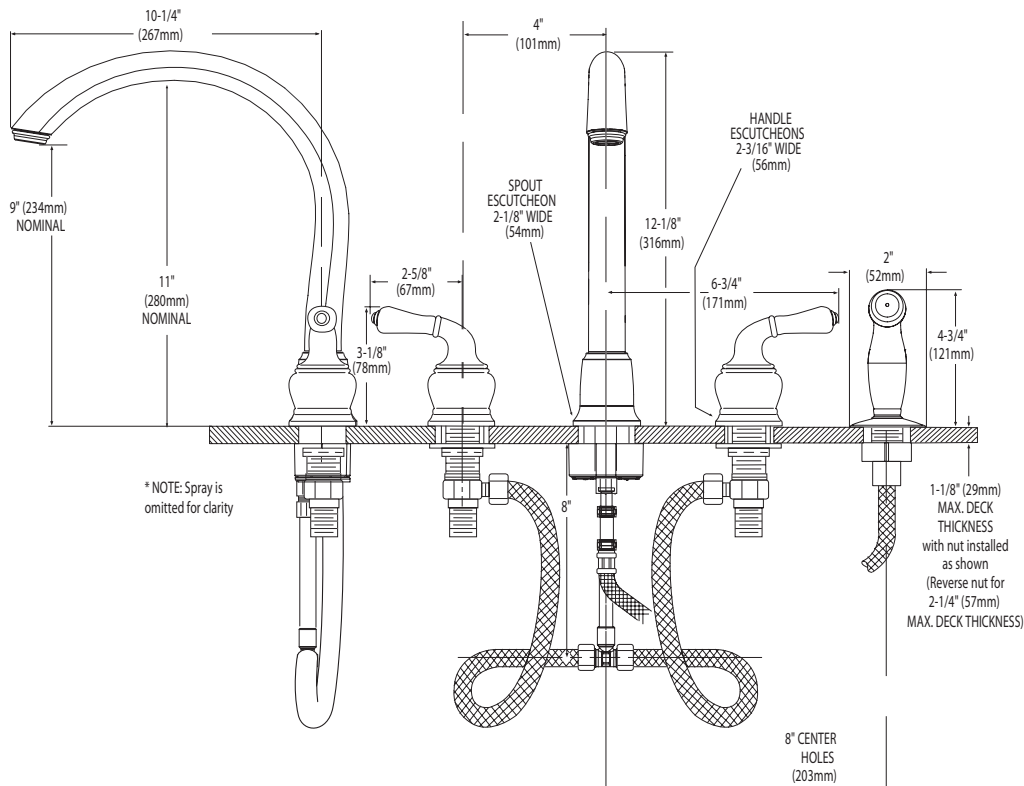

CRITICAL DIMENSIONS

(DO NOT SCALE)